

NOTICE!!

These documents have been scanned!

Do not place un-scanned documents beneath this notice!

Do not remove this notice from this file!

GPO Jacket No. 560-102
Print Order 61540
Rise Business Services, LLC
Job=AZ15 5/2/2019



Box Number= AZ15017



Claim Begin-End: AMC437944-AMC437947

1 Initial Receipt



AZ15017-7

AMC437915-AMC438337

United States Department of the Interior
Bureau of Land Management
 DIV OF LANDS, MINRLS & ENERGY
 ONE N CENTRAL AVE
 PHOENIX, AZ 85004 -4427
 Phone:

Receipt

No: 3542545

Transaction #: 3644861	
Date of Transaction: 04/21/2016	
CUSTOMER:	
ROSE GOLD EXPLORATION LLC 10408 S 16TH AVE PHOENIX,AZ 85041-9112 US	

LINE #	QTY	DESCRIPTION	REMARKS	UNIT PRICE	TOTAL
1	4.00	LOCATABLE MINERALS / MINING CLAIMS-NEW,UNADJUD, ONE OR MORE AUTH NOS / NEW MINING CLAIMS LOCATION FEE CASES: AMC437944/\$37.00, AMC437945/\$37.00, AMC437946/\$37.00, AMC437947/\$37.00		- n/a -	148.00
2	4.00	LOCATABLE MINERALS / MINING CLAIMS-NEW,UNADJUD, ONE OR MORE AUTH NOS / NEW MINING CLAIM PROCESSING FEE CASES: AMC437944/\$20.00, AMC437945/\$20.00, AMC437946/\$20.00, AMC437947/\$20.00		- n/a -	80.00
3	4.00	LOCATABLE MINERALS / MINING CLAIMS-NEW,UNADJUD, ONE OR MORE AUTH NOS / NEW MINING CLAIMS MAINTENANCE FEE CASES: AMC437944/\$155.00, AMC437945/\$155.00, AMC437946/\$155.00, AMC437947/\$155.00		- n/a -	620.00
TOTAL:					\$848.00

PAYMENT INFORMATION			
NOTE: Items will appear on credit card statement as "Bureau of Land Mgmt CO".			
1	AMOUNT:	848.00	POSTMARKED: N/A
	TYPE:	CREDIT CARD	RECEIVED: 04/21/2016
	NAME:	TRIPATHI, ROHIT K 10408 S 16TH AVE PHOENIX AZ 85041-9112 US	
	CARD NO:	XXXXXXXXXXXX2916	AUTH CODE: 491950
	NAME ON CARD:	ROHIT K TRIPATHI	

	EXPIRES: 10/2018
	SIGNATURE:

REMARKS

This receipt was generated by the automated BLM Collections and Billing System and is a paper representation of a portion of the official electronic record contained therein.

NOTICE!!

These documents have been scanned!

Do not place un-scanned documents beneath this notice!

Do not remove this notice from this file!

GPO Jacket No. 560-102
Print Order 61540
Rise Business Services, LLC
Job=AZ15 5/2/2019



Box Number= AZ15017



Claim Begin-End: AMC437944-AMC437947

2 Correspondence



AZ15017-7 AMC437915-AMC438337

**NO
DOCUMENTS
FOUND**

NO DOCUMENTS FOUND
NO DOCUMENTS FOUND

NOTICE!!

These documents have been scanned!

Do not place un-scanned documents beneath this notice!

Do not remove this notice from this file!

GPO Jacket No. 560-102
Print Order 61540
Rise Business Services, LLC
Job=AZ15 5/2/2019



Box Number= AZ15017



Claim Begin-End: AMC437944-AMC437947

3 Transfers



AZ15017-7

AMC437915-AMC438337

**NO
DOCUMENTS
FOUND**

NO DOCUMENTS FOUND
NO DOCUMENTS FOUND

NOTICE!!

These documents have been scanned!

Do not place un-scanned documents beneath this notice!

Do not remove this notice from this file!

GPO Jacket No. 560-102
Print Order 61540
Rise Business Services, LLC
Job=AZ15 5/2/2019



Box Number= AZ15017



Claim Begin-End: AMC437944-AMC437947

4 Annual Filings



AZ15017-7

AMC437915-AMC438337

Run Date: 08/07/18

Run Time: 04:41 PM

**DEPARTMENT OF THE INTERIOR
BUREAU OF LAND MANAGEMENT
MINING CLAIMS**

MC Maintenance Fees Paid Through the BLM Pay Portal

CBS Receipt: 4225584

Printed For Lead File # AMC437944

Agency Tracking ID: 1533128511

Assessment Year: 2019

Number of BLM Serial Nr: 4

Paid On: 08/01/2018

Total Amount Paid: \$620.00

Claim Name	BLM Serial No	Lead File No	Amount Paid
RG1	AMC437944	AMC437944	\$155.00
RG2	AMC437945	AMC437944	\$155.00
RG3	AMC437946	AMC437944	\$155.00
RG4	AMC437947	AMC437944	\$155.00

**United States Department of the Interior
Bureau of Land Management
BUSINESS & SUPPORT SVCS DIV
ONE N CENTRAL AVE SUITE 800
PHOENIX, AZ 85004 -4427
Phone: 602-417-9200**

Receipt

No: 4225584

Transaction #: 4340829	
Date of Transaction: 08/01/2018	
CUSTOMER:	
ROHIT TRIPATHI 10408 S 16TH AVENUE PHOENIX, AZ 85041 US	

LINE #	QTY	DESCRIPTION	REMARKS	UNIT PRICE	TOTAL
1	1.00	LOCATABLE MINERALS / MINING CLAIMS- NOT NEW-UNADJUD, ONE AUTH NO. ONLY / MINING CLAIM MONEY RECEIVED CASES: AMC437944/\$620.00		- n/a -	620.00
TOTAL:					\$620.00

PAYMENT INFORMATION			
NOTE: Items will appear on credit card statement as "BLM O Mining Claim".			
1	AMOUNT:	620.00	POSTMARKED: N/A
	TYPE:	CREDIT CARD	RECEIVED: 08/01/2018
	NAME:	ROHIT TRIPATHI 10408 S 16TH AVENUE PHOENIX AZ 85041 US	
	CARD NO:	XXXXXXXXXXXX4352	AUTH CODE: 73740T
	NAME ON CARD:	ROHIT TRIPATHI	
	SIGNATURE:		

REMARKS

This receipt was generated by the automated BLM Collections and Billing System and is a paper representation of a portion of the official electronic record contained therein.

Run Date: 08/28/17

Run Time: 12:44 PM

**DEPARTMENT OF THE INTERIOR
BUREAU OF LAND MANAGEMENT
MINING CLAIMS**

MC Maintenance Fees Paid Through the BLM Pay Portal

CBS Receipt: 3953864

Printed For Lead File # AMC437944

Agency Tracking ID: 1503498168

Assessment Year: 2018

Number of BLM Serial Nr: 4

Paid On: 08/23/2017

Total Amount Paid: \$620.00

Claim Name	BLM Serial No	Lead File No	Amount Paid
RG1	AMC437944	AMC437944	\$155.00
RG2	AMC437945	AMC437944	\$155.00
RG3	AMC437946	AMC437944	\$155.00
RG4	AMC437947	AMC437944	\$155.00

United States Department of the Interior
Bureau of Land Management
 BUSINESS & SUPPORT SVCS DIV
 ONE N CENTRAL AVE SUITE 800
 PHOENIX, AZ 85004 -4427
 Phone: 602-417-9200

Receipt

No: 3953864

Transaction #: 4063611	
Date of Transaction: 08/23/2017	
CUSTOMER:	
ROHIT K. TRIPATHI 10408 S 16TH AVENUE PHOENIX, AZ 85041 US	

LINE #	QTY	DESCRIPTION	REMARKS	UNIT PRICE	TOTAL
1	1.00	LOCATABLE MINERALS / MINING CLAIMS- NOT NEW-UNADJUD, ONE AUTH NO. ONLY / MINING CLAIM MONEY RECEIVED CASES: AMC437944/\$620.00		- n/a -	620.00
TOTAL:					\$620.00

PAYMENT INFORMATION			
NOTE: Items will appear on credit card statement as "BLM O Mining Claim".			
1	AMOUNT:	620.00	POSTMARKED: N/A
	TYPE:	CREDIT CARD	RECEIVED: 08/23/2017
	NAME:	ROHIT K. TRIPATHI 10408 S 16TH AVENUE PHOENIX AZ 85041 US	
	CARD NO:	XXXXXXXXXXXX7509	AUTH CODE: 64837P
	NAME ON CARD:	ROHIT K. TRIPATHI	
	EXPIRES:	04/2018	
	SIGNATURE:		

REMARKS

This receipt was generated by the automated BLM Collections and Billing System and is a paper representation of a portion of the official electronic record contained therein.

Run Date: 08/28/17

Run Time: 12:44 PM

**DEPARTMENT OF THE INTERIOR
BUREAU OF LAND MANAGEMENT
MINING CLAIMS**

MC Maintenance Fees Paid Through the BLM Pay Portal

CBS Receipt: 3953865

Printed For Lead File # AMC437944

Agency Tracking ID: 1503498362

Assessment Year: 2018

Number of BLM Serial Nr: 4

Paid On: 08/23/2017

Total Amount Paid: \$620.00

Claim Name	BLM Serial No	Lead File No	Amount Paid
RG1	AMC437944	AMC437944	\$155.00
RG2	AMC437945	AMC437944	\$155.00
RG3	AMC437946	AMC437944	\$155.00
RG4	AMC437947	AMC437944	\$155.00

United States Department of the Interior
Bureau of Land Management
 BUSINESS & SUPPORT SVCS DIV
 ONE N CENTRAL AVE SUITE 800
 PHOENIX, AZ 85004 -4427
 Phone: 602-417-9200

Receipt

No: 3953865

Transaction #: 4063613	
Date of Transaction: 08/23/2017	
CUSTOMER:	
	ROHIT K TRIPATHI 10408 S 16TH AVENUE PHOENIX, AZ 85041 US

LINE #	QTY	DESCRIPTION	REMARKS	UNIT PRICE	TOTAL
1	1.00	LOCATABLE MINERALS / MINING CLAIMS- NOT NEW-UNADJUD, ONE AUTH NO. ONLY / MINING CLAIM MONEY RECEIVED CASES: AMC437944/\$620.00		- n/a -	620.00
TOTAL:					\$620.00

PAYMENT INFORMATION					
NOTE: Items will appear on credit card statement as "BLM O Mining Claim".					
1	AMOUNT:	620.00	POSTMARKED:	N/A	
	TYPE:	CREDIT CARD	RECEIVED:	08/23/2017	
	NAME:	ROHIT K TRIPATHI 10408 S 16TH AVENUE PHOENIX AZ 85041 US			
	CARD NO:	XXXXXXXXXXXX7509	AUTH CODE:	85628P	
	NAME ON CARD:	ROHIT K TRIPATHI			
	EXPIRES:	04/2018			
	SIGNATURE:				

REMARKS

This receipt was generated by the automated BLM Collections and Billing System and is a paper representation of a portion of the official electronic record contained therein.

Run Date: 09/09/16

Run Time: 05:54 AM

**DEPARTMENT OF THE INTERIOR
BUREAU OF LAND MANAGEMENT
MINING CLAIMS**

MC Maintenance Fees Paid Through the BLM Pay Portal

CBS Receipt: 3638888

Printed For Lead File # **AMC437944**

Agency Tracking ID: 1471963853

Assessment Year: 2017

Number of BLM Serial Nr: 4

Paid On: 08/23/2016

Total Amount Paid: \$620.00

Claim Name	BLM Serial No	Lead File No	Amount Paid
RG1	AMC437944	AMC437944	\$155.00
RG2	AMC437945	AMC437944	\$155.00
RG3	AMC437946	AMC437944	\$155.00
RG4	AMC437947	AMC437944	\$155.00

**United States Department of the Interior
Bureau of Land Management
BUSINESS & SUPPORT SVCS DIV
ONE N CENTRAL AVE SUITE 800
PHOENIX, AZ 85004 -4427
Phone: (602) 417-9200**

Receipt

No: 3638888

Transaction #: 3742803	
Date of Transaction: 08/23/2016	
CUSTOMER:	
ROHIT K. TRIPATHI 10408 S 16TH AVENUE PHOENIX, AZ 85041 US	

LINE #	QTY	DESCRIPTION	REMARKS	UNIT PRICE	TOTAL
1	1.00	LOCATABLE MINERALS / MINING CLAIMS- NOT NEW-UNADJUD, ONE AUTH NO. ONLY / MINING CLAIM MONEY RECEIVED CASES: AMC437944/\$620.00		- n/a -	620.00
TOTAL:					\$620.00

PAYMENT INFORMATION			
NOTE: Items will appear on credit card statement as "BLM O Mining Claim".			
1	AMOUNT:	620.00	POSTMARKED: N/A
	TYPE:	CREDIT CARD	RECEIVED: 08/23/2016
	NAME:	ROHIT K. TRIPATHI 10408 S 16TH AVENUE PHOENIX AZ 85041 US	
	CARD NO:	XXXXXXXXXXXX9561	AUTH CODE: 862002
	NAME ON CARD:	ROHIT K. TRIPATHI	
	EXPIRES:	07/2020	
	SIGNATURE:		

REMARKS

This receipt was generated by the automated BLM Collections and Billing System and is a paper representation of a portion of the official electronic record contained therein.

NOTICE!!

These documents have been scanned!

Do not place un-scanned documents beneath this notice!

Do not remove this notice from this file!

GPO Jacket No. 560-102
Print Order 61540
Rise Business Services, LLC
Job=AZ15 5/2/2019



Box Number= AZ15017



Claim Begin-End: AMC437944-AMC437947

5 Miscellaneous



AZ15017-7

AMC437915-AMC438337

Amc 437944

United States Department of the Interior
Bureau of Land Management
 BUSINESS & SUPPORT SVCS DIV
 ONE N CENTRAL AVE SUITE 800
 PHOENIX, AZ 85004 -4427
 Phone: 602-417-9200

Receipt

No: 3953865

Transaction #: 4063613	
Date of Transaction: 08/23/2017	
CUSTOMER:	
ROHIT K TRIPATHI 10408 S 16TH AVENUE PHOENIX, AZ 85041 US	

LINE #	QTY	DESCRIPTION	REMARKS	UNIT PRICE	TOTAL
1	1.00	LOCATABLE MINERALS / MINING CLAIMS- NOT NEW-UNADJUD, ONE AUTH NO. ONLY / MINING CLAIM MONEY RECEIVED CASES: AMC437944/\$620.00		- n/a -	620.00
TOTAL:					\$620.00

PAYMENT INFORMATION			
NOTE: Items will appear on credit card statement as "BLM O Mining Claim".			
1	AMOUNT:	620.00	POSTMARKED: N/A
	TYPE:	CREDIT CARD	RECEIVED: 08/23/2017
	NAME:	ROHIT K TRIPATHI 10408 S 16TH AVENUE PHOENIX AZ 85041 US	
	CARD NO:	XXXXXXXXXXXX7509	AUTH CODE: 85628P
	NAME ON CARD:	ROHIT K TRIPATHI	
	EXPIRES:	04/2018	
	SIGNATURE:		

REMARKS

This receipt was generated by the automated BLM Collections and Billing System and is a paper representation of a portion of the official electronic record contained therein.

*REFUNDS FOR DUPLICATE PAYMENT
 OF 2018 MAINTENANCE FEES ON
 AMC 437944- AMC 437946.
 REFUND PROCESSED 8/28/2017. RM*

NOTICE!!

These documents have been scanned!

Do not place un-scanned documents beneath this notice!

Do not remove this notice from this file!

GPO Jacket No. 560-102
Print Order 61540
Rise Business Services, LLC
Job=AZ15 5/2/2019



Box Number= AZ15017



Claim Begin-End: AMC437944-AMC437947

6 Location Notices-Amendments and Supporting Documents



AZ15017-7 AMC437915-AMC438337

MINING CLAIM STATUS REPORT

Data Entered: 04/27/16 Rm

MTP Checked By: 04/27/16 Rm
GEO Checked By: 04/27/16 Rm

LEAD SERIAL NUMBER: AMC 437944 thru AMC 437947

NUMBER OF CLAIMS & TYPE:

CHARGES:

____ LODE
4 PLACER
____ ASSOCIATION PLACER
____ MILL SITE
____ TUNNEL SITE

Location Fee @ \$37 = \$ 148⁰⁰
Processing Fee @ \$20 = \$ 80⁰⁰
Maintenance Fee @ \$155 = \$ 620⁰⁰
Add'l Maint Fee for Assoc Placer = \$ _____
SUBTOTAL \$ 848⁰⁰
Other Fees \$ _____
Other Fees \$ _____
TOTAL \$ 848⁰⁰

TOTAL ACREAGE: 20 Per Claim
(Placer Only)

NUMBER OF LOCATORS: 1

DOCUMENTS RECEIVED VIA: Over-the-Counter Mail **TIMELY FILED:** Yes No

LEGAL DESCRIPTION: T 45 R 30E 3E SEC 6
T _____ R _____ SEC _____
T _____ R _____ SEC _____
T _____ R _____ SEC _____
T _____ R _____ SEC _____

BLM FOREST SERVICE SUBJ TO PL 359: Yes No
WILDERNESS AREA

SPLIT ESTATE: N/A SX PX OTHER
SRHA Was proper Notice filed if located on SHRA Land? Yes No

RECONVEYED MINERALS ON BLM LAND REQUIRE OPENING ORDER FROM 1944 TO 1993:
Open to Entry On _____ N/A

COMMENTS/STATUS: VOID PARTIALLY VOID PVT MINERALS WITHDRAWN LANDS
OTHER

[] Claimant acknowledges that portions of the following claim(s) site(s) may be void or voidable.

Printed Name of Claimant _____ Signature of Claimant _____

*****FINAL ADJUDICATION*****

DATE 1/17/2017 INITIALS AM

AMC 437944



LOCATION NOTICE FOR PLACER MINING CLAIM

NOTICE IS HEREBY GIVEN that the RG I

placer mining claim has been located by

Rose Gold Exploration LLC whose current mailing address is 10408 51st Ave
Phoenix, AZ 85041

RECEIVED	BLM AZ STATE OFFICE	2016 APR 21 P 3:46	PHOENIX, ARIZONA

The general course of this claim is North-south and it is situated in Greenlee County, Arizona.

This claim is 1320 feet in length and 660 feet in width. This claim runs from the location monument on which this location notice is posted approximately 1319 feet in a North direction to the North end line and 659 feet in a West direction to the West end line.

This claim is marked by four monuments, one at each corner of the claim.

The location monument on which this notice is posted is situated within Section 6, Township 4 S, Range 30 E, Gila Salt River Base and Meridian, Arizona. This claim encompasses portions of the following legal subdivision(s) if located by legal subdivision or the following quarter section (s), section (s), Township (s) and Range (s) SW 1/4 OF T4S R30E
Gila Salt River Base and Meridian, Arizona.

The locality of this claim with reference to some natural object or permanent monument and additional information (if any) concerning its locality are as follows: SW corner of claim is located at the SW corner of section 6

DATED AND POSTED on the ground this 21 day of April, 2016
LOCATOR (s) Robit Tripathi

AMC437944

(CORONADO MT)

mytopo

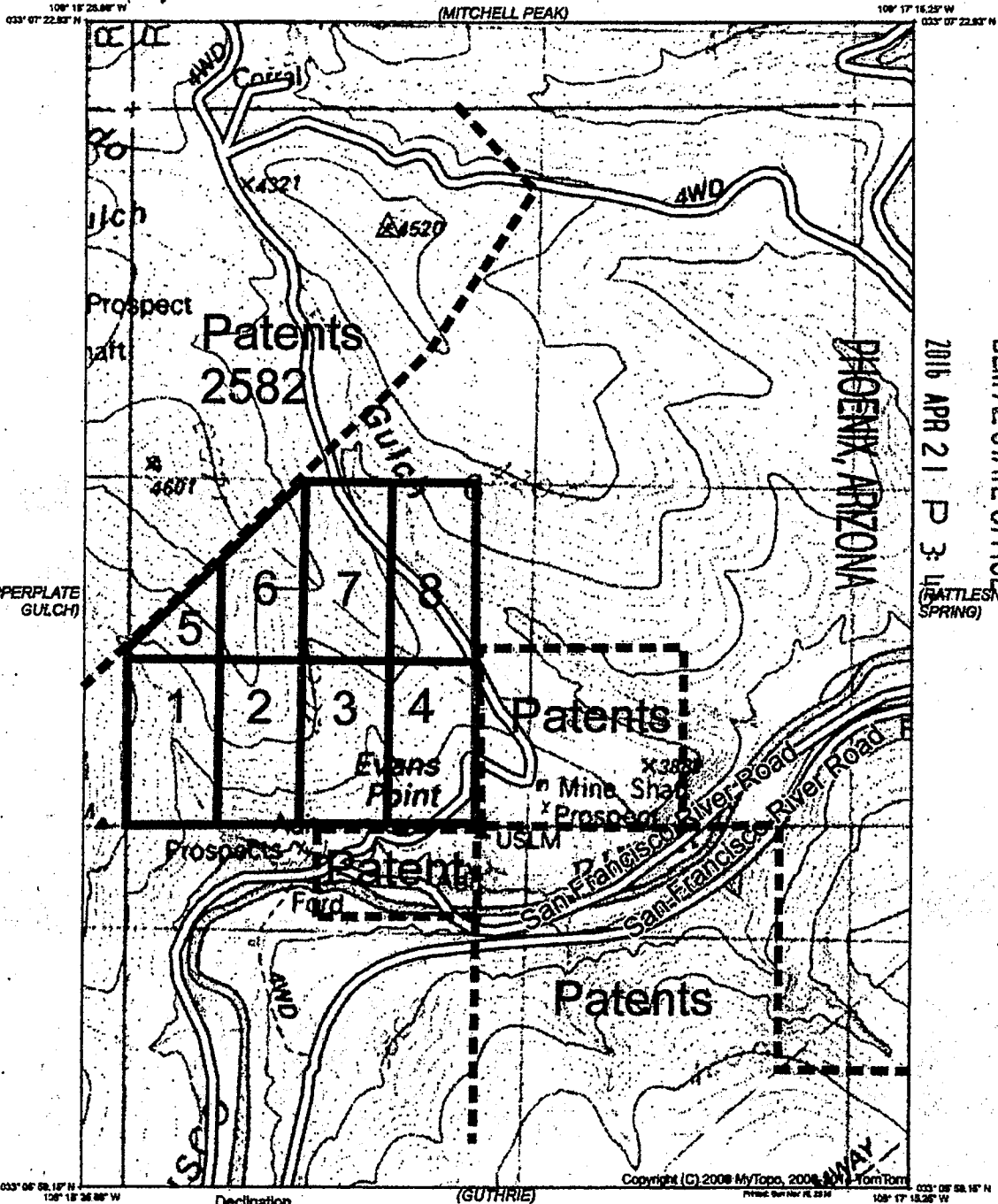

RECEIVED
BLM AZ STATE OFFICE
2016 APR 21 P 3:44
(RATTLESNAKE SPRING)

AMC437944

(GILA BOX)

Produced by MyTopo Terrain Navigator
Topography based on USGS 1:24,000 Maps
North American 1983 Datum (NAD83)
Transverse Mercator Projection
To place on the predicted North American 1927 move the projection lines 7M N and 69M W

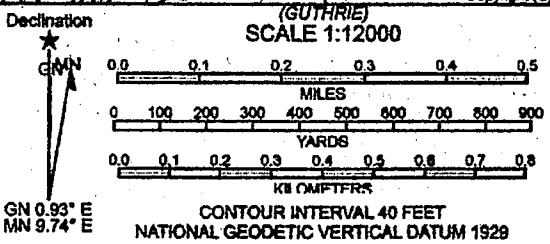

CLIFTON, AZ 1989

Claims in T4S R30E Section 6

1. The above map depicts the RG mining claim, which is located in Section (s) 6, Township 4S, Range 30E, Gila and Salt River Base and Meridian, GREENLEE County, Arizona.

2. The type of corner and location monuments used are as follows: WOOD POSTS

3. The bearings and distances in degrees and feet between claim corners are as depicted on the map.

Form MCF100a
Revised July 2005



LOCATION NOTICE FOR PLACER MINING CLAIM

NOTICE IS HEREBY GIVEN that the RG2

RECEIVED
BLM AZ STATE OFFICE
2016 APR 21 P 3:46
PHOENIX, ARIZONA
BLM
Date
Stamp

placer mining claim has been located by
Rose Gold Exploration LLC whose current mailing
address is 10408 S 16th Ave
Phoenix, AZ 85041

The general course of this claim is North-South and it is situated in
Greenlee County, Arizona.

This claim is 1320 feet in length and 660 feet in width. This claim runs from the
location monument on which this location notice is posted approximately 1310 feet in a North
direction to the North end line and 659 feet in a East direction to the East end line.

This claim is marked by four monuments, one at each corner of the claim.

The location monument on which this notice is posted is situated within Section 6, Township
4 S, Range 30 E, Gila Salt River Base and Meridian, Arizona. This claim encompasses
portions of the following legal subdivision(s) if located by legal subdivision or the following quarter section (s),
section (s), Township (s) and Range (s) SW 1/4 of T4S R30E
Gila Salt River Base and Meridian, Arizona.

The locality of this claim with reference to some natural object or permanent monument and additional
information (if any) concerning its locality are as follows: SW corner of claim is
located 660 ft East of the SW corner
of section 6

DATED AND POSTED on the ground this 21 day of April, 2016

LOCATOR (s) Rohit Tripathi

AMC437945

(CORONADO MT)

mytopo

CLIFTON QUADRANGLE ARIZONA TOPOGRAPHIC SERIES (DIX CREEK)

100° 15' 25.94" W 033° 07' 22.83" N (MITCHELL PEAK) 100° 17' 15.25" W 033° 07' 22.83" N

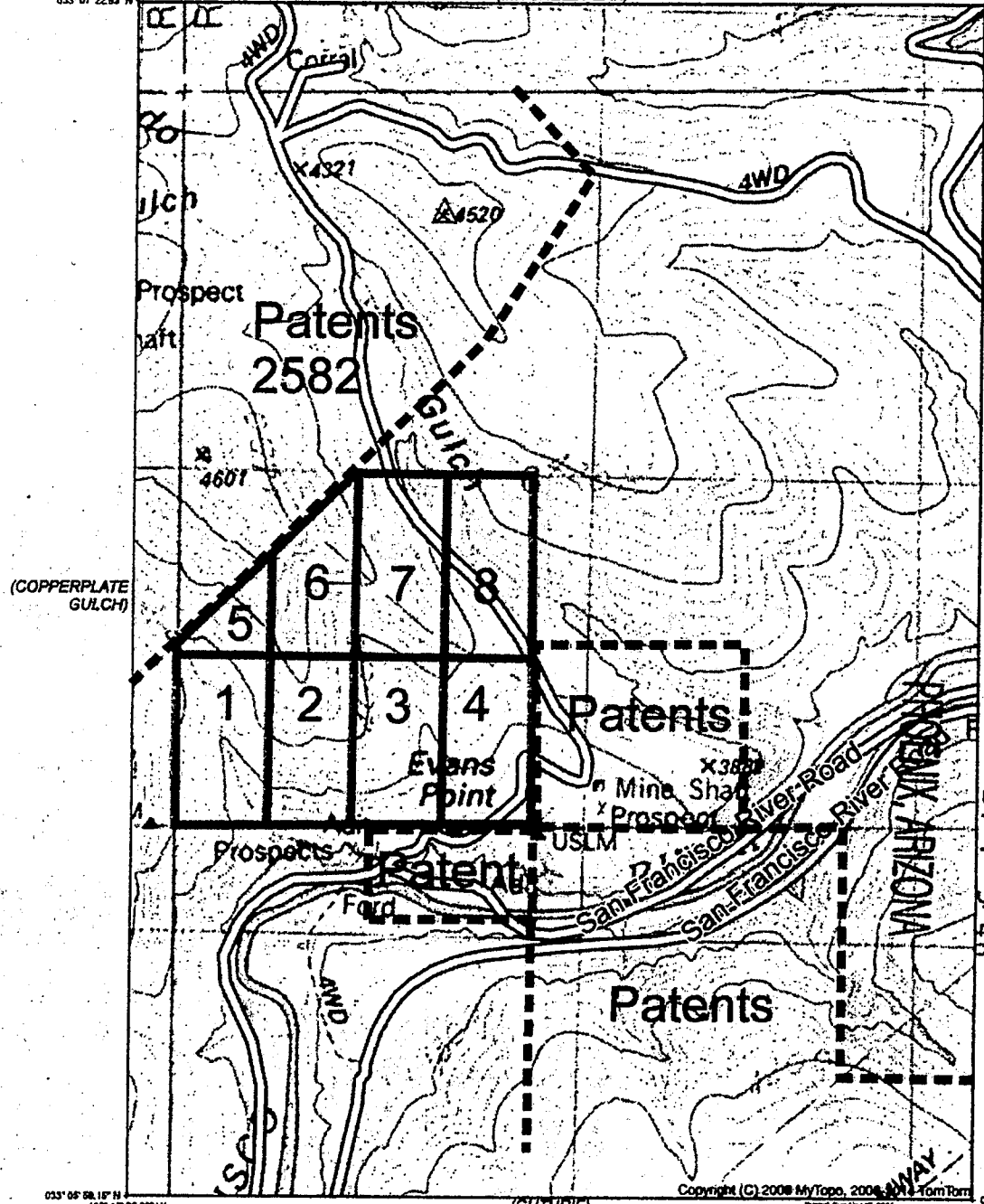

(COPPERPLATE GULCH)

(RATTLESNAKE SPRING)

RECEIVED BLM AZ STATE OFFICE 2016 APR 21 P 3:48

(GILA BOX)

Produced by MyTopo Terrain Navigator
 Topography based on USGS 1:24,000 Maps
 North American 1983 Datum (NAD83)
 Transverse Mercator Projection
 To place on the predicted North American 1927 move the projection lines 7M N and 59M W

Declination

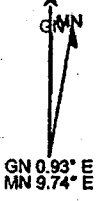

(GUTHRIE) SCALE 1:12000

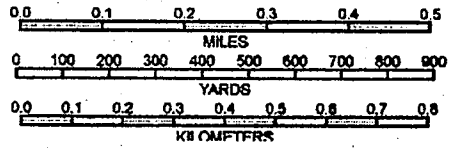

CONTOUR INTERVAL 40 FEET NATIONAL GEODETIC VERTICAL DATUM 1929

CLIFTON, AZ 1989

Claims in T4S R30E Section 6

1. The above map depicts the RG mining claim, which is located in Section (s) 6, Township 4S, Range 30E, Gila and Salt River Base and Meridian, GREENLEE County, Arizona.

2. The type of corner and location monuments used are as follows: WOOD POSTS

3. The bearings and distances in degrees and feet between claim corners are as depicted on the map.

Form MCF100a Revised July 2005

AMC437945



LOCATION NOTICE FOR PLACER MINING CLAIM

NOTICE IS HEREBY GIVEN that the RG3

_____ placer mining claim has been located by

ROSEGOLD Exploration LLC whose current mailing

address is 10408 S 16th Ave

Phoenix, AZ 85041

RECEIVED
BLM AZ STATE OFFICE
2016 APR 21 P 3:46
PHOENIX, ARIZONA

BLM
Date
Stamp

The general course of this claim is North-South and it is situated in Greenlee County, Arizona.

This claim is 1320 feet in length and 660 feet in width. This claim runs from the location monument on which this location notice is posted approximately 1319 feet in a North direction to the North end line and 659 feet in a West direction to the West end line.

This claim is marked by four monuments, one at each corner of the claim.

The location monument on which this notice is posted is situated within Section 6, Township 4 S, Range 30 E, Gila Salt River Base and Meridian, Arizona. This claim encompasses

portions of the following legal subdivision(s) if located by legal subdivision or the following quarter section (s),

section (s), Township (s) and Range (s) SW 1/4 of T4S R30E

_____, Gila Salt River Base and Meridian, Arizona.

The locality of this claim with reference to some natural object or permanent monument and additional information (if any) concerning its locality are as follows: SW corner of claim is located 1320ft East of the SW corner of section 6

DATED AND POSTED on the ground this 21 day of April, 2016

LOCATOR (s) Rohit Tripathi

AMC 4379461

(CORONADO MT)

mytopo

CLIFTON QUADRANGLE ARIZONA TOPOGRAPHIC SERIES (DIX CREEK)

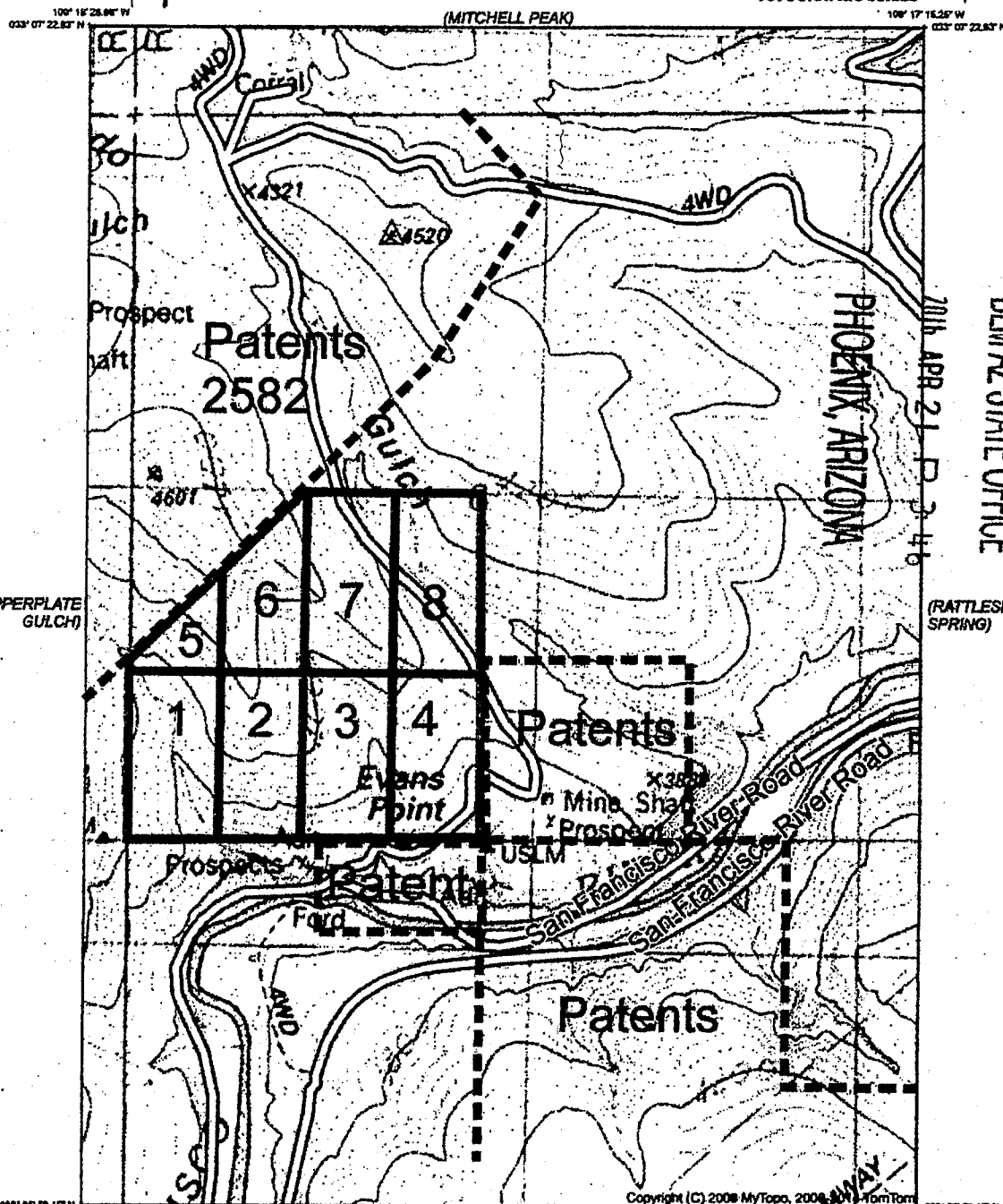

RECEIVED
BLM AZ STATE OFFICE

AMC 437946

(GILA BOX)

Produced by MyTopo Terrain Navigator
Topography based on USGS 1:24,000
Maps

North American 1983 Datum (NAD83)
Transverse Mercator Projection

To place on the predicted North American
1927 move the projection lines 7M N and
69M W

Declination
★
GMN
GN 0.93° E
MN 9.74° E

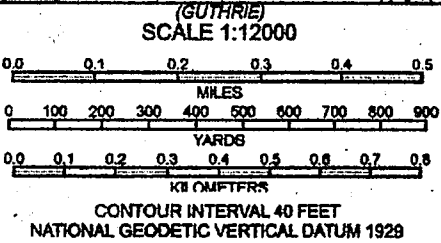

CLIFTON, AZ
1989

Claims in T4S R30E
Section 6

1. The above map depicts the RG mining claim, which is located in Section (s)
6 Township 4S, Range 30E, Gila and Salt River Base and Meridian,
GREENLEE County, Arizona.

2. The type of corner and location monuments used are as follows: WOOD POSTS

3. The bearings and distances in degrees and feet between claim corners are as depicted on the map.

Form MCF100a
Revised July 2005



LOCATION NOTICE FOR PLACER MINING CLAIM

NOTICE IS HEREBY GIVEN that the RG4

placer mining claim has been located by

RoseGold Exploration LLC whose current mailing
address is 10408 516th Ave
Phoenix, AZ 85041

RECEIVED
BLM AZ STATE OFFICE
2016 APR 21 P 3:46
PHOENIX, ARIZONA
BLM
Date
Stamp

The general course of this claim is North-South and it is situated in
Greenlee County, Arizona.

This claim is 1320 feet in length and 660 feet in width. This claim runs from the
location monument on which this location notice is posted approximately 1319 feet in a North
direction to the North end line and 659 feet in a East direction to the East end line.

This claim is marked by four monuments, one at each corner of the claim.

The location monument on which this notice is posted is situated within Section 6, Township
4 S, Range 30 E, Gila Salt River Base and Meridian, Arizona. This claim encompasses
portions of the following legal subdivision(s) if located by legal subdivision or the following quarter section (s),
section (s), Township (s) and Range (s) SW 1/4 of T4S R30E

Gila Salt River Base and Meridian, Arizona.

The locality of this claim with reference to some natural object or permanent monument and additional
information (if any) concerning its locality are as follows: SW corner of claim
is located at 1980 ft east of the SW
corner of section 6

DATED AND POSTED on the ground this 21 day of April, 2016

LOCATOR (s) Rohit K. Tripathi

AMC437947

(CORONADO MT)



CLIFTON QUADRANGLE
ARIZONA
TOPOGRAPHIC SERIES (DIX CREEK)

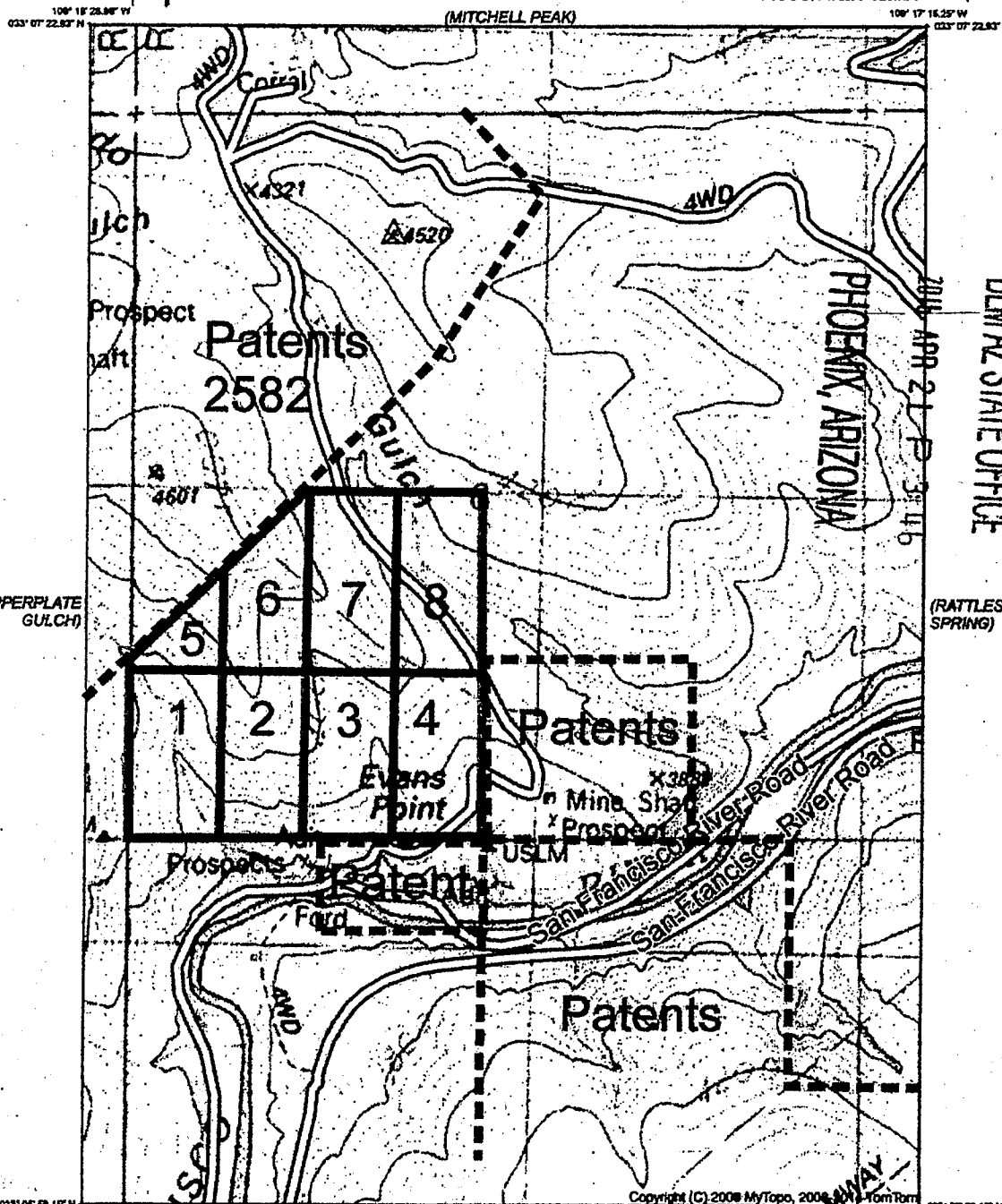

RECEIVED
BLM AZ STATE OFFICE

(RATTLESNAKE SPRING)

(COPPERPLATE GULCH)

Copyright (C) 2008 MyTopo, 2008 Tom Rom

(GILA BOX)

Produced by MyTopo Terrain Navigator
Topography based on USGS 1:24,000
Maps

North American 1983 Datum (NAD83)
Transverse Mercator Projection

To place on the predicted North American
1927 move the projection lines 7M N and
58M W

Declination



GN 0.93° E
MN 9.74° E

(GUTHRIE)
SCALE 1:12000



CONTOUR INTERVAL 40 FEET
NATIONAL GEODETIC VERTICAL DATUM 1929

CLIFTON, AZ
1989

**Claims in T4S R30E
Section 6**

1. The above map depicts the RG mining claim, which is located in Section (s)
6, Township 4S, Range 30E, Gila and Salt River Base and Meridian,
GREENLEE County, Arizona.

2. The type of corner and location monuments used are as follows: WOOD POSTS

3. The bearings and distances in degrees and feet between claim corners are as depicted on the map.

Form MCF100a
Revised July 2005

AMC4319471

DEPARTMENT OF INTERIOR
BUREAU OF LAND MANAGEMENT

Input Parameters for Geographic Report with Land

System Id = CR

Admin State = AZ

Geo State =

Casetype Begins With

Case Disp Txt = AUTHORIZED, CANCELLED, EXPIRED, PENDING, REJECTED, RELINQUISHED, VOID, WITHDRAWN

Mer Twp Rng = 14 0040S 0300E

Section = 006, 999

Mtrs =

Commodity =

Commodity Txt =

Pending Org =

Pend Org Decode =

Total Rows Returned: 1

RUN TIME: 03:49 PM

Adm State: AZ

UNITED STATES DEPARTMENT OF INTERIOR
BUREAU OF LAND MANAGEMENT
GEOGRAPHIC REPORT WITH LAND
Sorted by Meridian Township Range

RUN DATE: 04/21/2016
Page 1 of 1

Serial Number: AZA 035686

Total Case Acres: 1.000

<u>Casetype</u>	<u>Case Disp</u>				<u>Sect</u>	<u>Sur Typ</u>	<u>Sur Num</u>	<u>Suff</u>	<u>Subdivision</u>	<u>Act Pend</u>
380913	AUTHORIZED	14	0040S	0300E	006	MNR			SESWSW;	

